

LAGE&SA

A



FERRAGENS



A1 . PUXADORES E ASAS
A2 . FECHADURAS E CILINDROS
A3 . DOBRADIÇAS E PIVOTS
A4 . FECHOS E BATENTES



A5 . SISTEMAS DE CORRER

A6 . MOLAS P/ PORTAS
A7 . PORTAS
A8 . ANTI-PÂNICO
A9 . VEDAÇÕES
A10 . CREMONES E OSCILO-BATENTES
A11 . SISTEMAS MODULARES
A12 . DIVERSOS



CAIXILHOS P/ PORTAS DE CORRER EMBUTIDAS



A5.1

O modelo base de toda a gama OPENSPACE é composto por um caixilho de folha única de embutir para aplicação de uma porta de correr em madeira ou vidro.
O ÚNICO apresenta uma enorme versatilidade de utilização, sendo a solução ideal para economizar espaço em habitações, espaços comerciais e hoteleiros.

	Interior caixilho	Exterior caixilho	Parede (min.)	Porta (max.)
Gesso cartonado	49	70	96	35
	69	90	116	55
Tijolo	49	70	96	35
	69	90	116	55

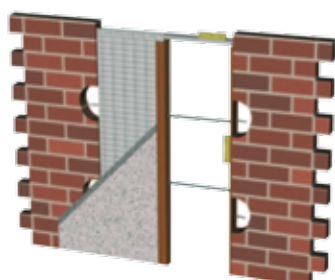
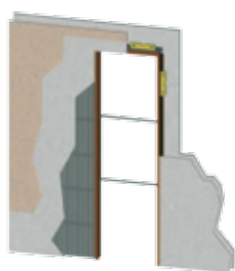

Dimensão porta		Vão de obra total	Dimensão porta		Vão de obra total
Largura	Altura		Largura	Altura	
600	2000	1300 x 2080	1000	2000	2100 x 2080
	2100	1300 x 2180		2100	2100 x 2180
	2200	1300 x 2280		2200	2100 x 2280
	2300	1300 x 2380		2300	2100 x 2380
	2400	1300 x 2480		2400	2100 x 2480
	2500	1300 x 2580		2500	2100 x 2580
700	2000	1500 x 2080	1100	2000	2300 x 2080
	2100	1500 x 2180		2100	2300 x 2180
	2200	1500 x 2280		2200	2300 x 2280
	2300	1500 x 2380		2300	2300 x 2380
	2400	1500 x 2480		2400	2300 x 2480
	2500	1500 x 2580		2500	2300 x 2580
750	2000	1600 x 2080	1200	2000	2500 x 2080
	2100	1600 x 2180		2100	2500 x 2180
	2200	1600 x 2280		2200	2500 x 2280
	2300	1600 x 2380		2300	2500 x 2380
	2400	1600 x 2480		2400	2500 x 2480
	2500	1600 x 2580		2500	2500 x 2580
800	2000	1700 x 2080	1300	2000	2700 x 2080
	2100	1700 x 2180		2100	2700 x 2180
	2200	1700 x 2280		2200	2700 x 2280
	2300	1700 x 2380		2300	2700 x 2380
	2400	1700 x 2480		2400	2700 x 2480
	2500	1700 x 2580		2500	2700 x 2580
900	2000	1900 x 2080	1400	2000	2900 x 2080
	2100	1900 x 2180		2100	2900 x 2180
	2200	1900 x 2280		2200	2900 x 2280
	2300	1900 x 2380		2300	2900 x 2380
	2400	1900 x 2480		2400	2900 x 2480
	2500	1900 x 2580		2500	2900 x 2580

CAIXILHOS P/ PORTAS DE CORRER EMBUTIDAS



Desenvolvido para ambientes espaçosos, o sistema ENCONTRO permite a aplicação de duas portas de correr opostas embutidas na parede. O ENCONTRO permite separar facilmente salas, escritórios ou ateliers e criar espaços modernos e funcionais.

	Interior caixilho	Exterior caixilho	Parede (min.)	Porta (max.)
Gesso cartonado	49	70	96	35
	69	90	116	55
Tijolo	49	70	96	35
	69	90	116	55

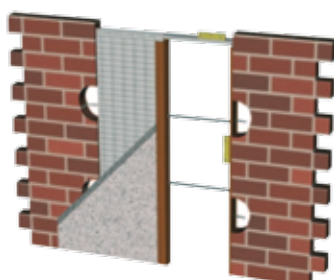
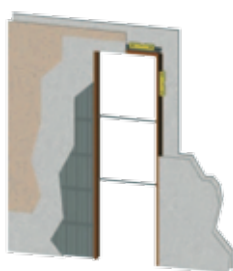

Dimensão porta		Vão de obra total	Dimensão porta		Vão de obra total
Largura	Altura		Largura	Altura	
1200 (600+600)	2000	2470 x 2080	2000 (1000+1000)	2000	4070 x 2080
	2100	2470 x 2180		2100	4070 x 2180
	2200	2470 x 2280		2200	4070 x 2280
	2300	2470 x 2380		2300	4070 x 2380
	2400	2470 x 2480		2400	4070 x 2480
1400 (700+700)	2500	2470 x 2580	2200 (1100+1100)	2500	4070 x 2580
	2000	2870 x 2080		2000	4470 x 2080
	2100	2870 x 2180		2100	4470 x 2180
	2200	2870 x 2280		2200	4470 x 2280
	2300	2870 x 2380		2300	4470 x 2380
1500 (750+750)	2400	2870 x 2480	2400 (1200+1200)	2400	4470 x 2480
	2500	2870 x 2580		2500	4470 x 2580
	2000	3170 x 2080		2000	4870 x 2080
	2100	3170 x 2180		2100	4870 x 2180
	2200	3170 x 2280		2200	4870 x 2280
1600 (800+800)	2300	3170 x 2380	2600 (1300+1300)	2300	4870 x 2380
	2400	3170 x 2480		2400	4870 x 2480
	2500	3170 x 2580		2500	4870 x 2580
	2000	3270 x 2080		2000	5270 x 2080
	2100	3270 x 2180		2100	5270 x 2180
1800 (900+900)	2200	3270 x 2280	2800 (1400+1400)	2200	5270 x 2280
	2300	3270 x 2380		2300	5270 x 2380
	2400	3270 x 2480		2400	5270 x 2480
	2500	3270 x 2580		2500	5270 x 2580
	2000	3670 x 2080		2000	5670 x 2080
	2100	3670 x 2180		2100	5670 x 2180
	2200	3670 x 2280		2200	5670 x 2280
	2300	3670 x 2380		2300	5670 x 2380
	2400	3670 x 2480		2400	5670 x 2480
	2500	3670 x 2580		2500	5670 x 2580

A5.2

CAIXILHOS P/ PORTAS DE CORRER EMBUTIDAS



A5.3

Pensado para clientes exigentes, o PARALELO permite a aplicação de duas portas de correr sobrepostas que recolhem para um único caixilho lateral, criando uma maior amplitude de vão e a incorporação de uma solução estética e funcional.

	Interior caixilho	Exterior caixilho	Parede (min.)	Porta (max.)
Gesso cartonado	129	150	176	55
Tijolo	129	150	176	55

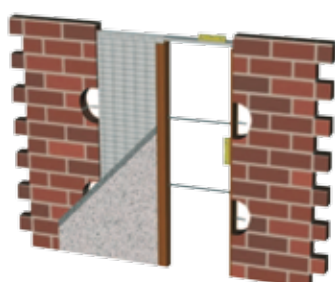
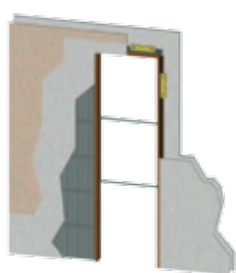

Dimensão porta		Vão de obra total	Dimensão porta		Vão de obra total
Largura	Altura		Largura	Altura	
1200 (600+600)	2000	1860 x 2080	2000 (1000+1000)	2000	3060 x 2080
	2100	1860 x 2180		2100	3060 x 2180
	2200	1860 x 2280		2200	3060 x 2280
	2300	1860 x 2380		2300	3060 x 2380
	2400	1860 x 2480		2400	3060 x 2480
1400 (700+700)	2500	1860 x 2580	2200 (1100+1100)	2500	3060 x 2580
	2000	2160 x 2080		2000	3360 x 2080
	2100	2160 x 2180		2100	3360 x 2180
	2200	2160 x 2280		2200	3360 x 2280
	2300	2160 x 2380		2300	3360 x 2380
1500 (750+750)	2400	2160 x 2480	2400 (1200+1200)	2400	3360 x 2480
	2500	2160 x 2580		2500	3360 x 2580
	2000	2310 x 2080		2000	3760 x 2080
	2100	2310 x 2180		2100	3760 x 2180
	2200	2310 x 2280		2200	3760 x 2280
1600 (800+800)	2300	2310 x 2380	2600 (1300+1300)	2300	3760 x 2380
	2400	2310 x 2480		2400	3760 x 2480
	2500	2310 x 2580		2500	3760 x 2580
	2000	2460 x 2080		2000	3960 x 2080
	2100	2460 x 2180		2100	3960 x 2180
1800 (900+900)	2200	2460 x 2280	2800 (1400+1400)	2200	3960 x 2280
	2300	2460 x 2380		2300	3960 x 2380
	2400	2460 x 2480		2400	3960 x 2480
	2500	2460 x 2580		2500	3960 x 2580
	2000	2760 x 2080		2000	4260 x 2080
	2100	2760 x 2180		2100	4260 x 2180
	2200	2760 x 2280		2200	4260 x 2280
	2300	2760 x 2380		2300	4260 x 2380
	2400	2760 x 2480		2400	4260 x 2480
	2500	2760 x 2580		2500	4260 x 2580

SISTEMA DE CORRER PARA PORTAS

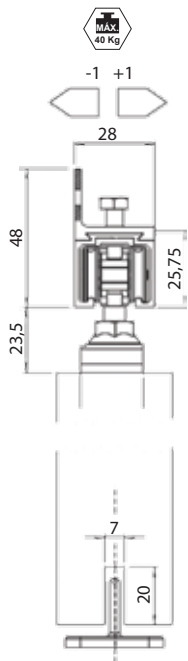
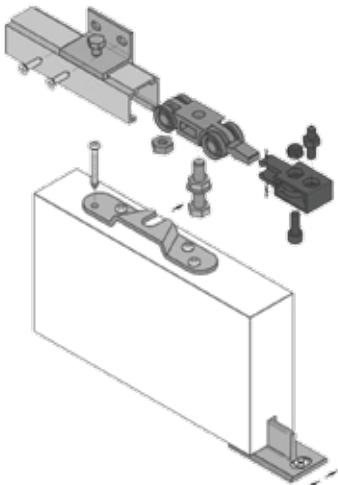
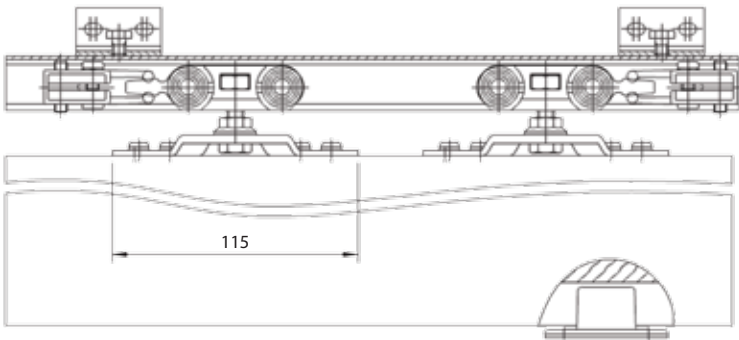

CALHA KRONA K40 KIT



Referência	Código	Acabamento
K40-50x70 (1100)	150K405070	ALU.ANODIZADO
K40-71x90 (1600)	150K407190	ALU.ANODIZADO
K40-91x120 (2000)	150K4091120	ALU.ANODIZADO
K40-121x150 (2300)	150K40121150	ALU.ANODIZADO

SUPORTE 0400/5



Código

15004005

OPCIONAL

SISTEMA DE CORRER PARA PORTAS

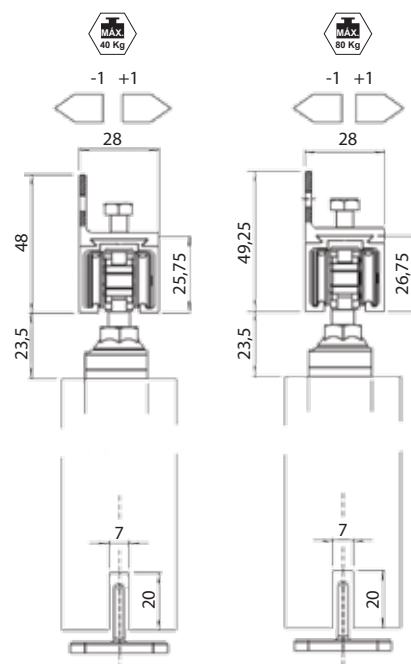
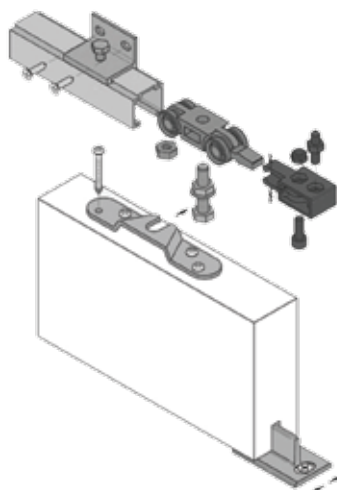
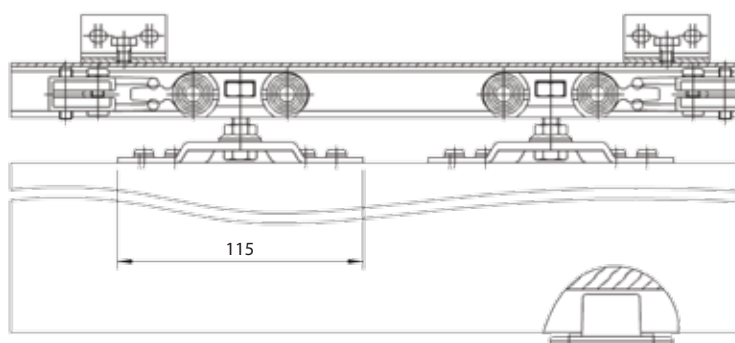

CALHA KRONA	Refer.	Código	Acabamento	CALHA KRONA	Refer.	Código	Acabamento
	4001	150400	ALU. NATURAL		4002	1504002	ALU. NATURAL
	4011	1504011	ALU. ANODIZADO		4012	1504012	ALU. ANODIZADO

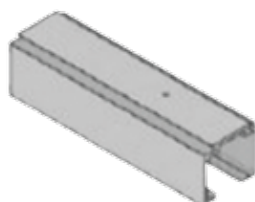

SUPORTE 0400/5



Código

15004005

OPCIONAL

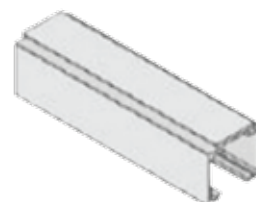

CARRO 0400/3 KRONA - 40 kg	Código	CARRO 0400/4 KRONA - 80 kg	Código
	15004003		15004004



SISTEMA DE CORRER PARA PORTAS

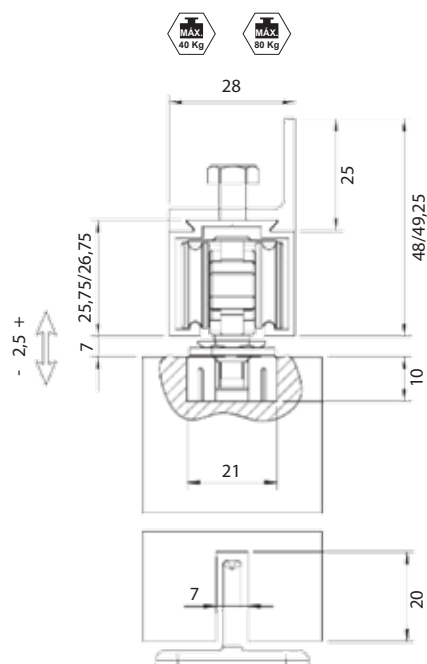
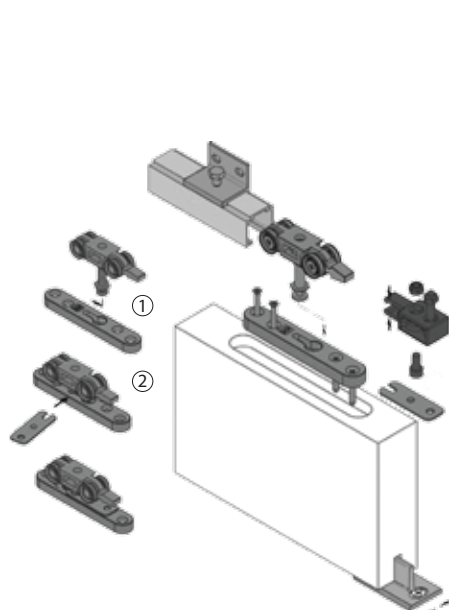
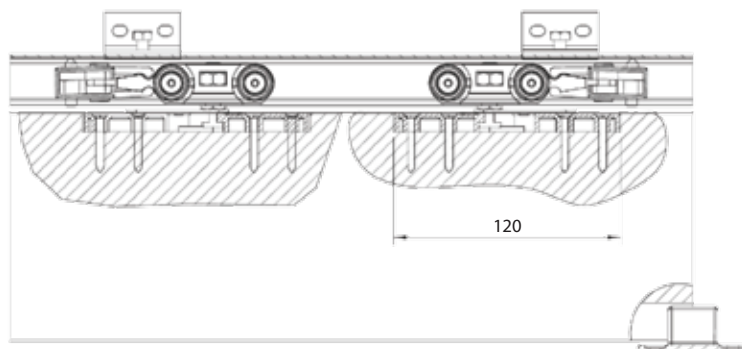

A5.6

FERRAGENS > SISTEMAS DE CORRER > SISTEMA 0450/40/80

CALHA KRONA	Refer.	Código	Acabamento	CALHA KRONA	Refer.	Código	Acabamento
  	4001	150400	ALU. NATURAL	  	4002	1504002	ALU. NATURAL
	4011	1504011	ALU. ANODIZADO		4012	1504012	ALU. ANODIZADO

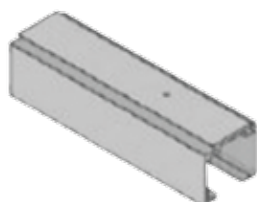

SUPORTE 0400/5

Código

15004005

OPCIONAL

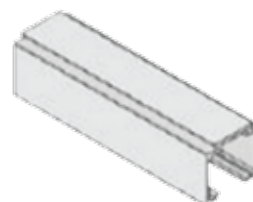

CARRO 0450/3 KRONA - 40 kg	Código	CARRO 0450/4 KRONA - 80 kg	Código
	15004503		15004504



SISTEMA DE CORRER PARA PORTAS

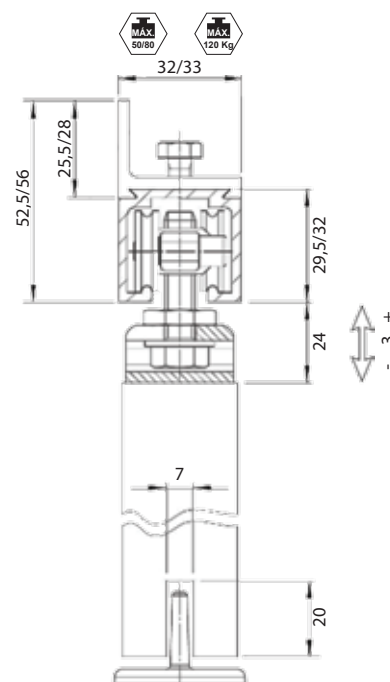
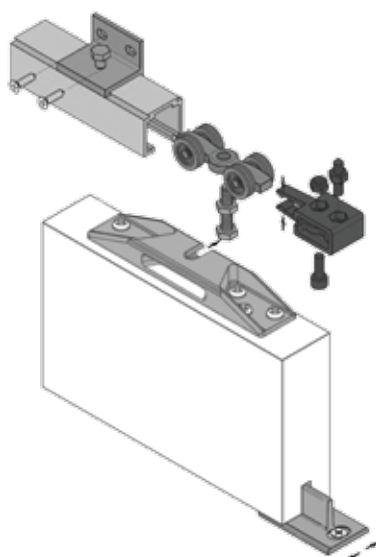
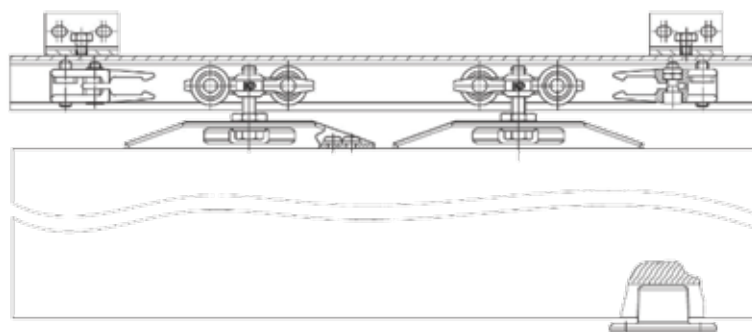

CALHA KRONA	Refer.	Código	Acabamento	CALHA KRONA	Refer.	Código	Acabamento
  	500	150500	ALU.ANODIZADO	  	5001	1505001	ALU.ANODIZADO

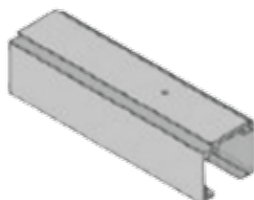

SUPORTE 0500/4



Código

15005004

OPCIONAL

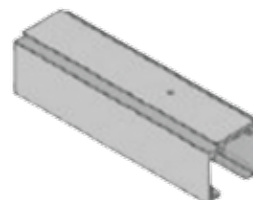

CARRO 0500/2 KRONA - 50 kg	Código	CARRO 0500/3 KRONA - 80/120 kg	Código
	15005002		15005003



SISTEMA DE CORRER PARA PORTAS

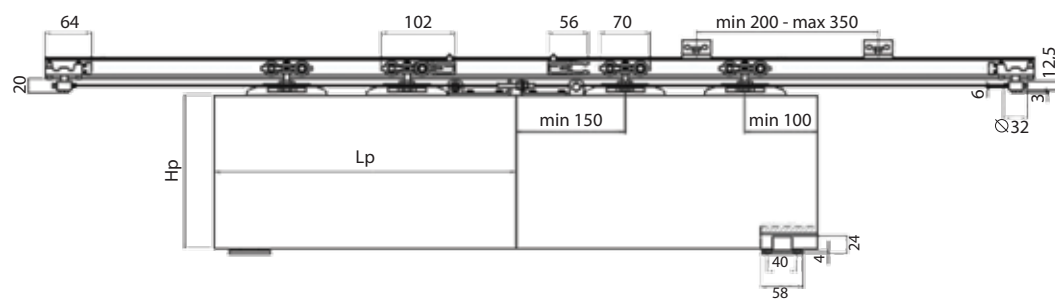



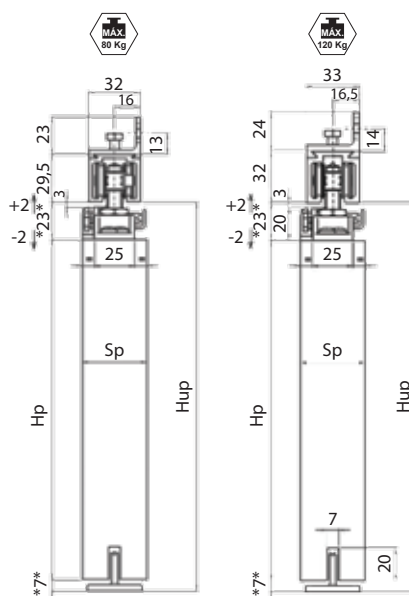
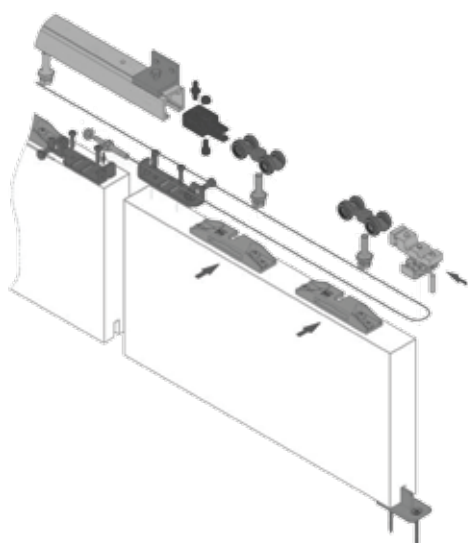









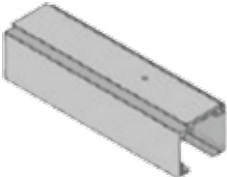
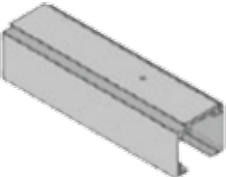

- Hp = Altura painel
- Sp = Espessura painel
- Hup = Área útil de passagem



A5.8

FERRAGENS > SISTEMAS DE CORRER > SISTEMA 0550/50/80/120

CALHA KRONA	Refer.	Código	Acabamento	CALHA KRONA	Refer.	Código	Acabamento
  	500	150500	ALU.ANODIZADO	  	5001	1505001	ALU.ANODIZADO
	SUPORTE 0500/4		Código		SUPORTE 0500/5		Código
	OPCIONAL				OPCIONAL		
CARRO 0550/1 KRONA - 50 kg			Código	CARRO 0550/2 KRONA - 80/120 kg			Código
	 				 		

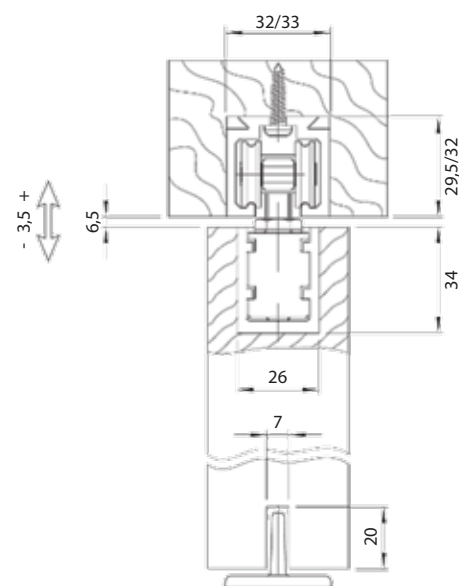
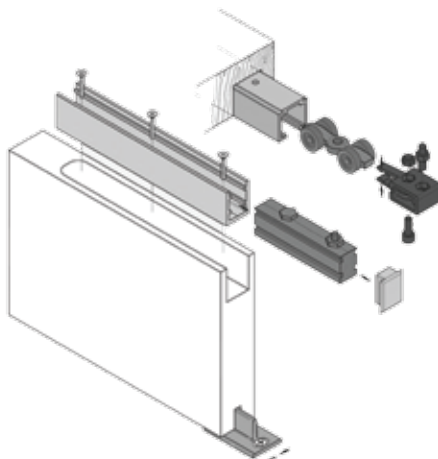
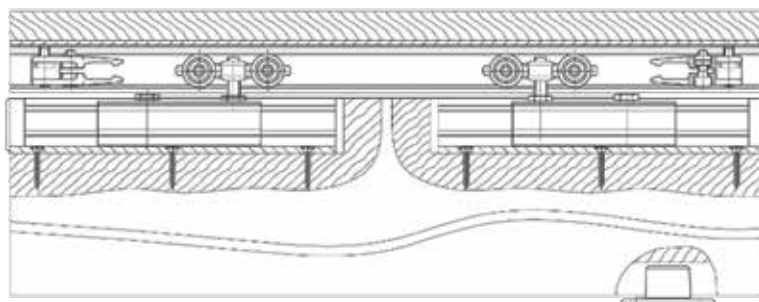

CALHA KRONA	Refer.	Código	Acabamento	CALHA KRONA	Refer.	Código	Acabamento
  	500	I50500	ALU.ANODIZADO	  	5001	I505001	ALU.ANODIZADO

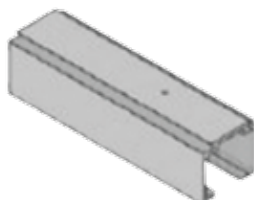

SUPORTE 0500/4

Código

I5005004

OPCIONAL

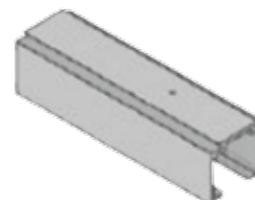
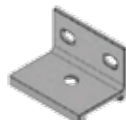

CARRO 0600/50 KRONA - 50 kg	Código	CARRO 0600/80 KRONA - 80/120 kg	Código
	I50060050		I50060080



SISTEMA DE CORRER PARA PORTAS

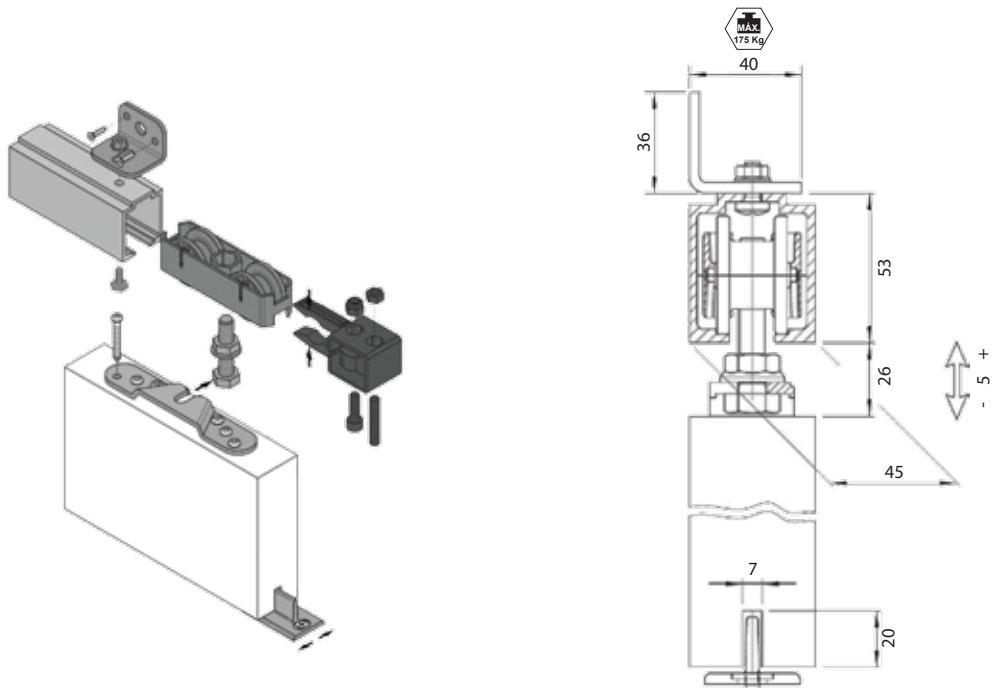
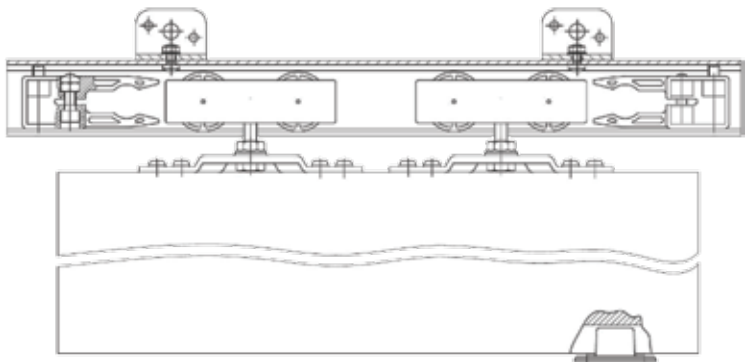

CALHA KRONA	Refer.	Código	Acabamento	SUPORTE 0850/5	Código
	830	I50830	ALU.ANODIZADO		OPCIONAL

CARRO 0830/3 KRONA - 175 kg



I5008303



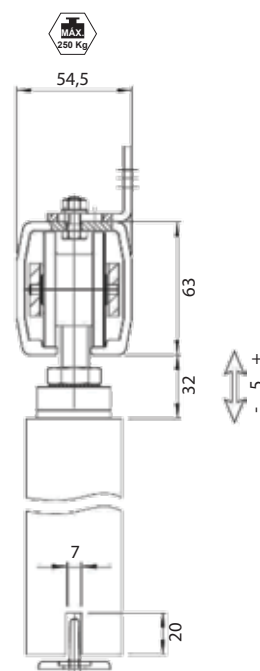
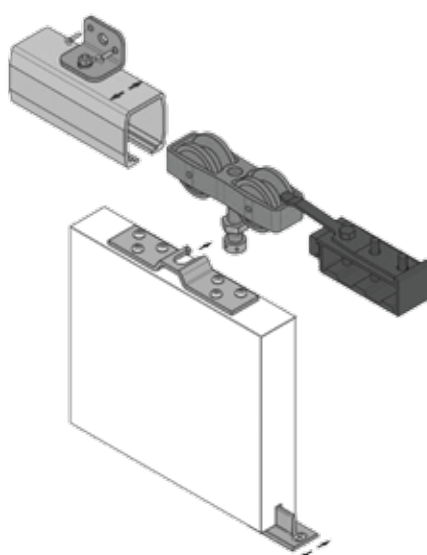
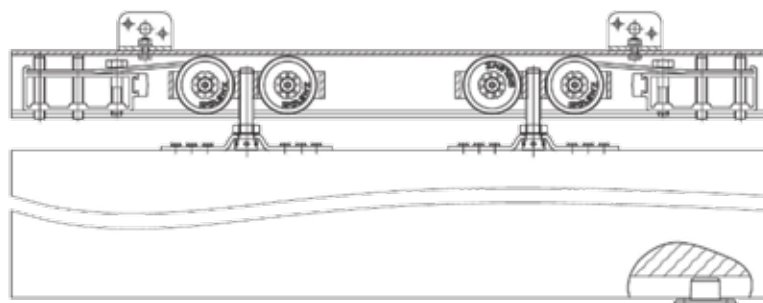

A5.11

FERRAGENS > SISTEMAS DE CORRER > SISTEMA 0850/250

CALHA KRONA	Refer.	Código	Acabamento	SUPORTE 0850/5	Código
	850	150850	ALU.ANODIZADO		OPCIONAL

CARRO 0850/3 KRONA - 250 kg



Código

15008503



SISTEMA DE CORRER PARA PORTAS

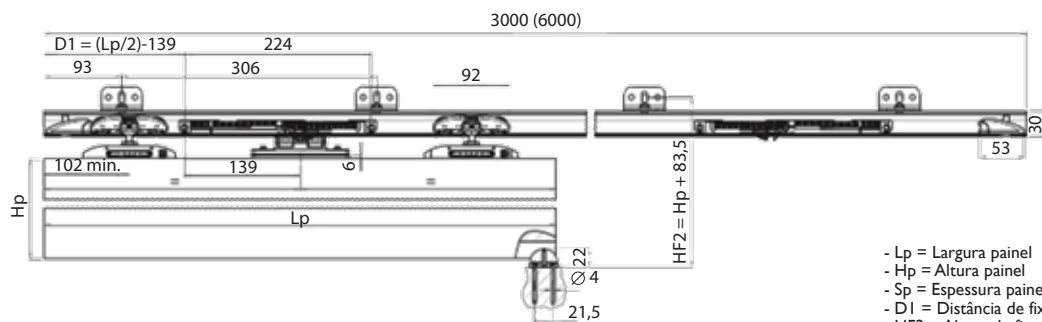

- Lp = Largura painel
- Hp = Altura painel
- Sp = Espessura painel
- D1 = Distância de fixação
- HF2 = Altura de fixação na parede
- HS2 = Altura do teto
- Hup = Área útil de passagem

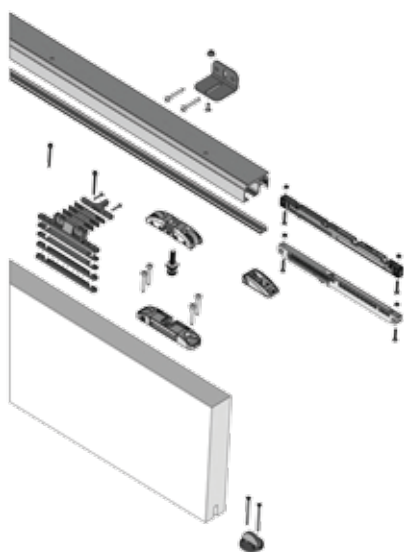

FIXAÇÃO COM SUPORTE

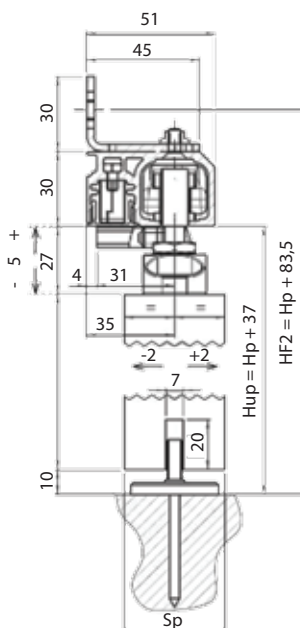

FIXAÇÃO COM PARAFUSOS

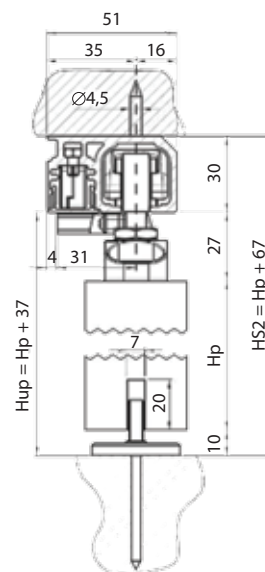

CALHA KART I ABS

Código

SUPORTE KART 8

Código



350KIABS

OPCIONAL

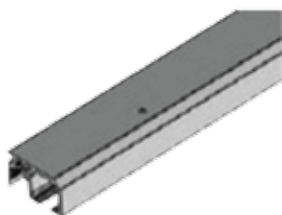

CARRO KART 40 ABS KRONA

Código

CARRO KART 80 ABS KRONA

Código



350K40ABS



350K80ABS



SISTEMA DE CORRER PARA PORTAS

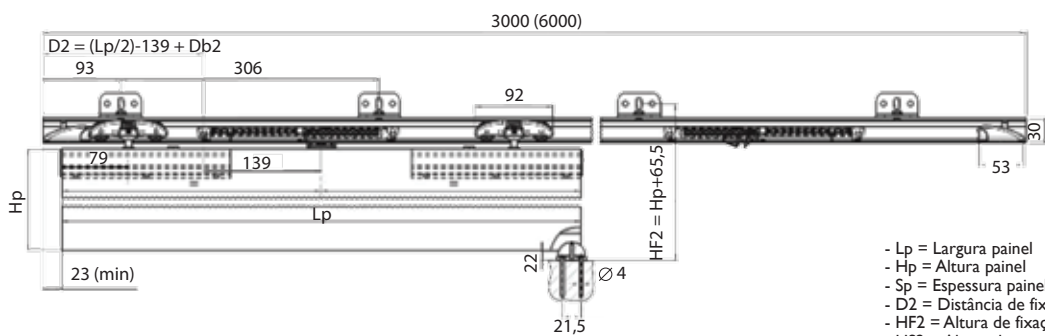

- Lp = Largura painel
- Hp = Altura painel
- Sp = Espessura painel
- D2 = Distância de fixação
- HF2 = Altura de fixação na parede
- HS2 = Altura do teto
- Hup = Área útil de passagem

FIXAÇÃO COM SUPORTE

FIXAÇÃO COM PARAFUSOS

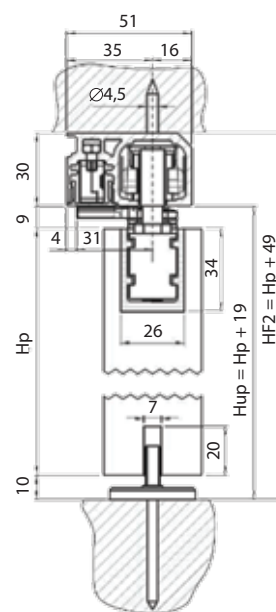
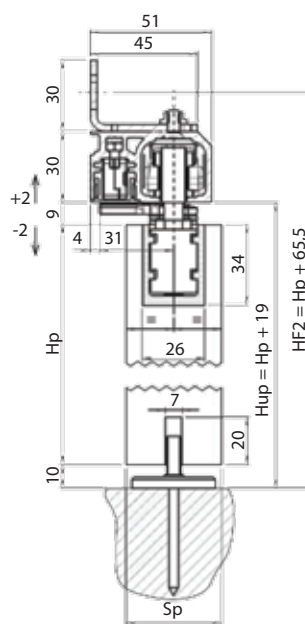
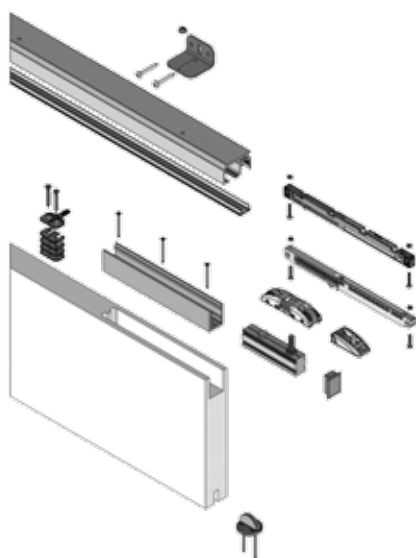

CALHA KART I ABS



Código

350KIABS

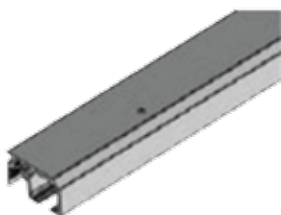

SUPORTE KART 8

Código

OPCIONAL



CARRO KART 0600/40 ABS KRONA

Código



CARRO KART 0600/80 ABS KRONA

Código



350K060080



SISTEMA DE CORRER PARA PORTAS

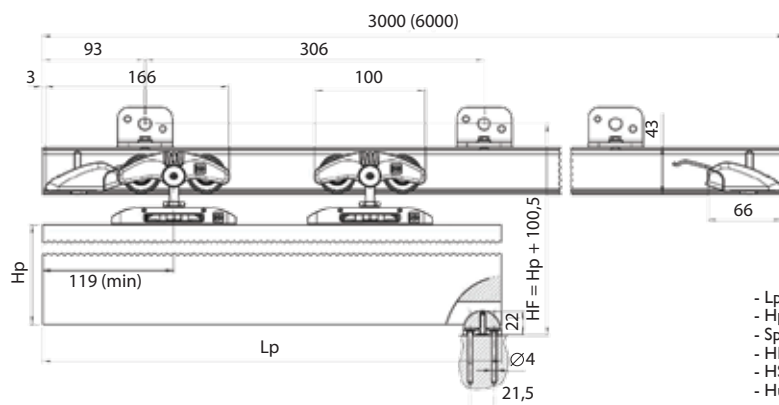

- Lp = Largura painel
- Hp = Altura painel
- Sp = Espessura painel
- HF = Altura de fixação na parede
- HS = Altura do teto
- Hup = Área útil de passagem

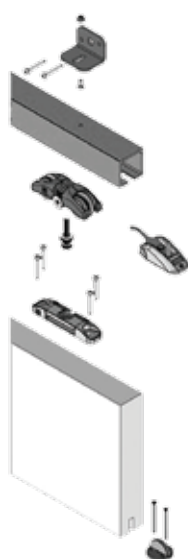



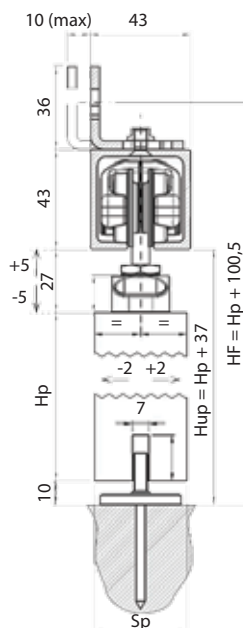

FIXAÇÃO COM SUPORTE

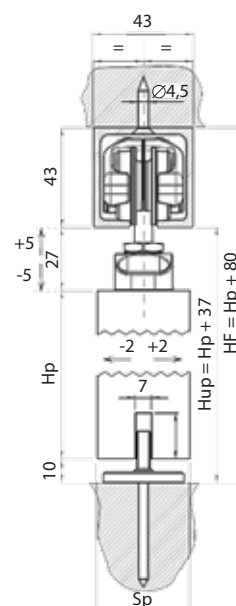

FIXAÇÃO COM PARAFUSOS



CALHA KART 2	Código	SUPOORTE KART 4	Código
  	350K2		OPCIONAL
			

CARRO KART 120	Código
	350K120



SISTEMA DE CORRER PARA PORTAS

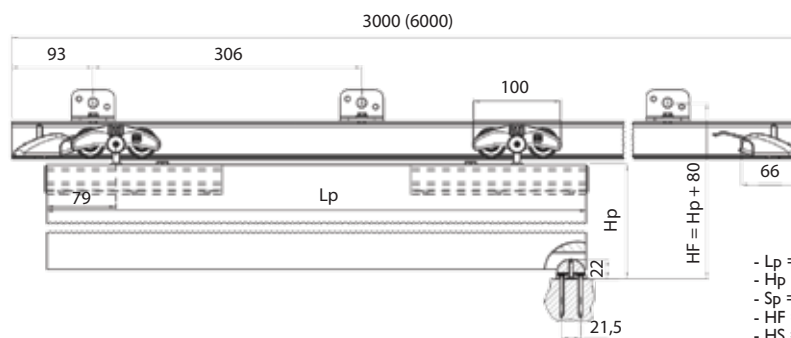

- Lp = Largura painel
- Hp = Altura painel
- Sp = Espessura painel
- HF = Altura de fixação na parede
- HS = Altura do teto
- Hup = Área útil de passagem

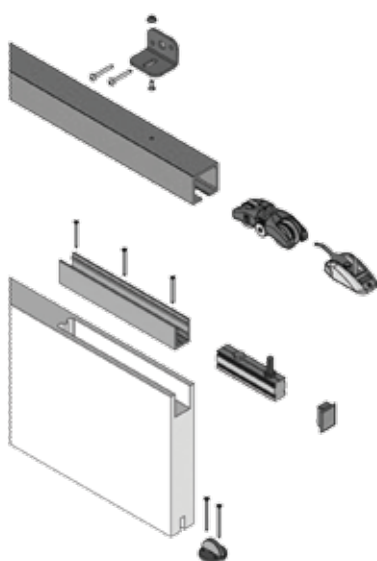

FIXAÇÃO COM SUPORTE

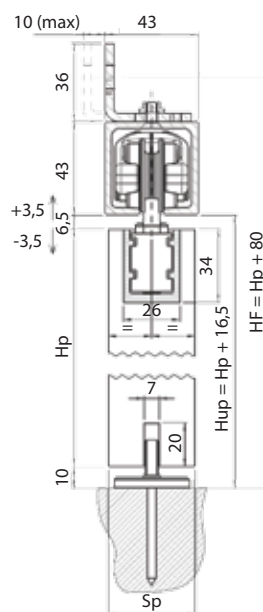

FIXAÇÃO COM PARAFUSOS

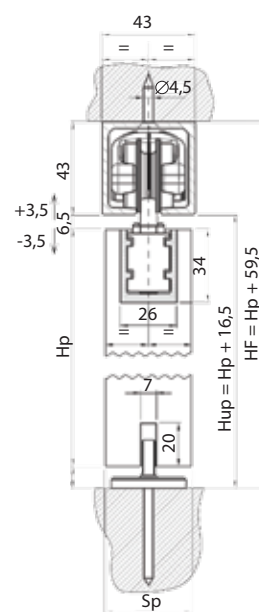

A5.15

FERRAGENS > SISTEMAS DE CORRER > SISTEMA K Art 120 + SYSTEM 0600

CALHA KART 2



Código

350K2

SUPORTE KART 4

Código

OPCIONAL



CARRO KART 0600/120

Código



350K0600120



SISTEMA DE CORRER PARA PORTAS

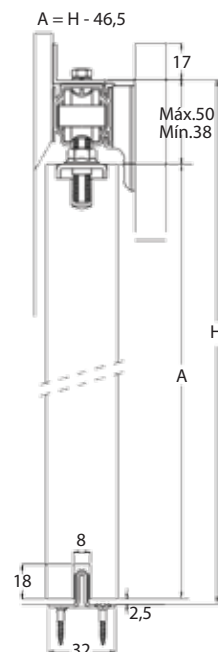
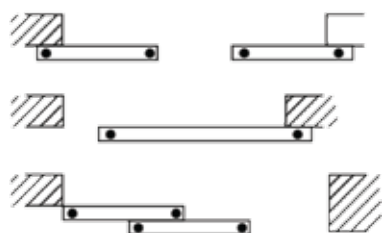
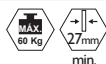

A5.16

FERRAGENS > SISTEMAS DE CORRER > SISTEMA SF-A60



CALHA 61	ALUMÍNIO	Código	Acabamento	CALHA 62 P/ PLADUR	ALUMÍNIO	Código
		15061	NATURAL			15062

CARRO SF-A60

Código



150SFA60



SISTEMA DE CORRER PARA PORTAS

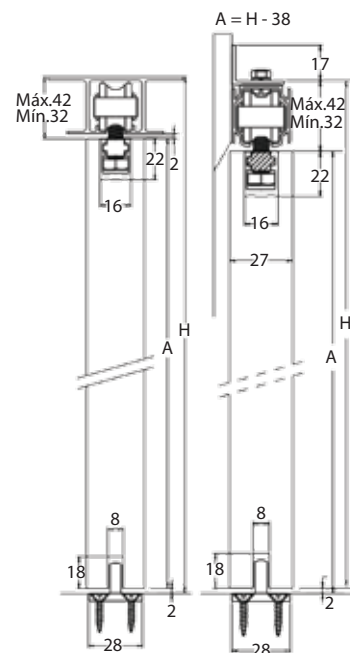
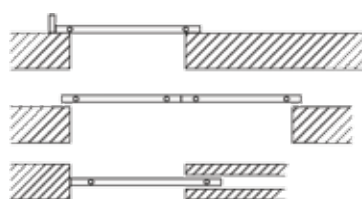
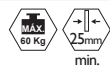

CALHA 61

ALUMÍNIO

Código

Acabamento

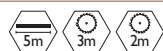

15061

NATURAL

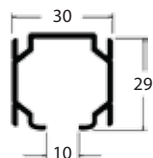

CALHA 62 P/ PLADUR

ALUMÍNIO

Código



15062

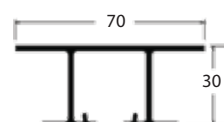
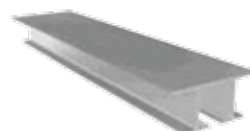

CARRO SF-RA60

Código



150SFRA60



SISTEMA DE CORRER PARA PORTAS

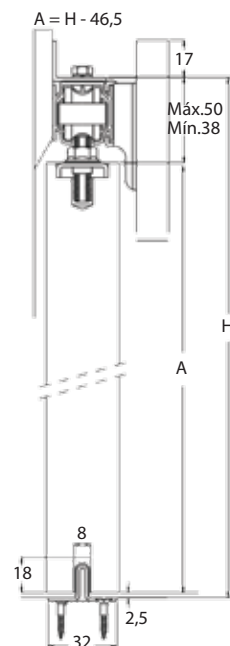
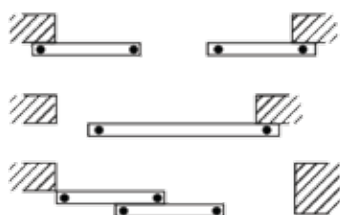
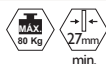

A5.18

FERRAGENS > SISTEMAS DE CORRER > SISTEMA SF-A80

CALHA 61	ALUMÍNIO	Código	Acabamento	CALHA 62 P/ PLADUR	ALUMÍNIO	Código
		15061	NATURAL			15062

CARRO SF-A80

Código



150SFA80



SISTEMA DE CORRER PARA PORTAS

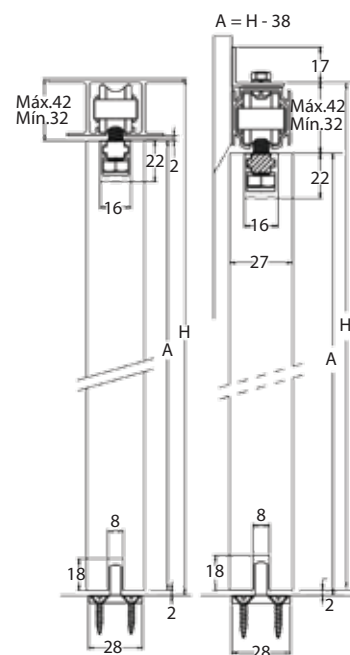
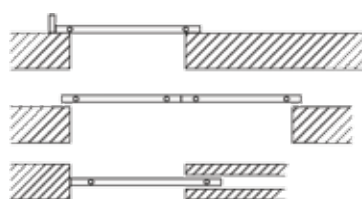
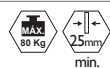

CALHA 61

ALUMÍNIO

Código

Acabamento



15061

NATURAL

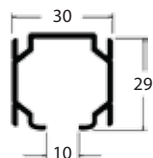

CALHA 62 P/ PLADUR

ALUMÍNIO

Código



15062

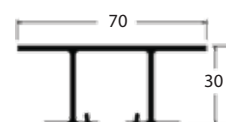
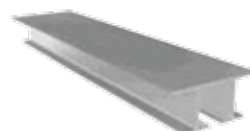

CARRO SF-RA80

Código



150SFRA80



SISTEMA DE CORRER PARA PORTAS

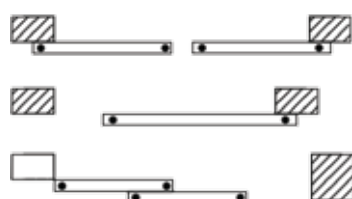

$$A = H - 60,5$$

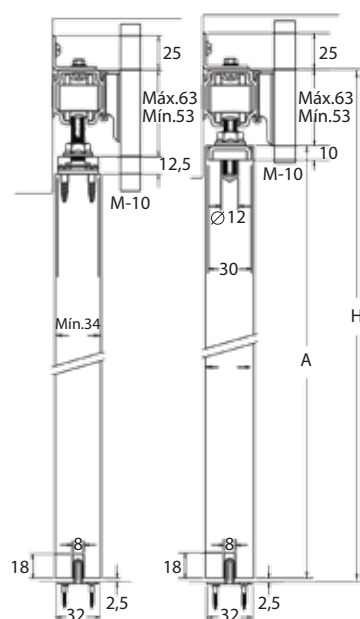

CALHA S-125 SUPERIOR



ALUMÍNIO

Código

Acabamento

150SI25

NATURAL

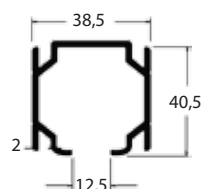

CARRO SF-A125



Código

150SFA125



SISTEMA DE CORRER PARA PORTAS

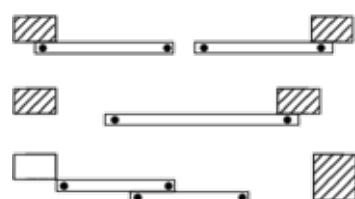

$$A = H - 50$$

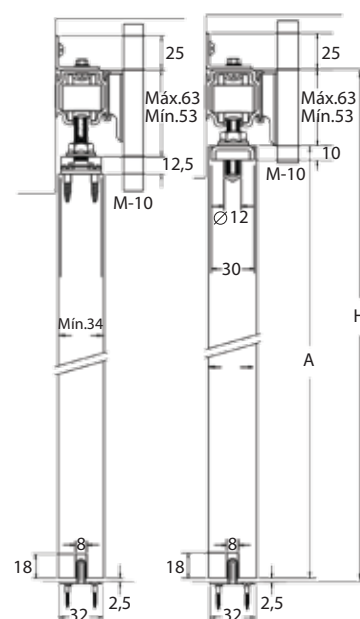

A5.21

FERRAGENS > SISTEMAS DE CORRER > SISTEMA SF-RA125

CALHA S-125 SUPERIOR

ALUMÍNIO

Código

Acabamento

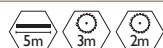

I50SI25

NATURAL

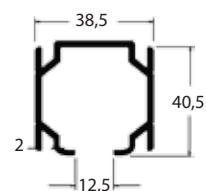

CARRO SF-RA125

Código



I50SFRA125



SISTEMA DE CORRER PARA PORTAS

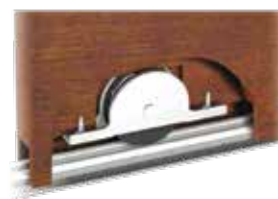
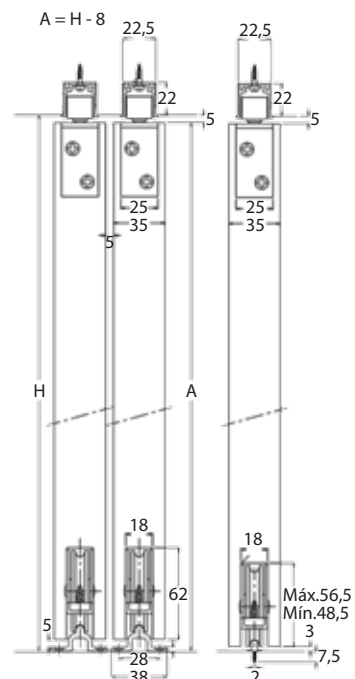
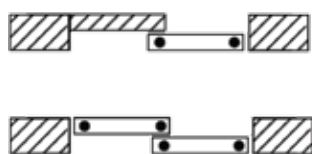

A5.22

FERRAGENS > SISTEMAS DE CORRER > SISTEMA SF-150

CALHA 41		ALUMÍNIO	Código	Acabamento	CARRO SF-150		Código
			I5041	NATURAL			I50SF150
CALHA 51		ALUMÍNIO	Código	Acabamento	CALHA 52		Código
			I5051	NATURAL			I5052
			I5051D	DOURADO			NATURAL

SISTEMA DE CORRER PARA PORTAS

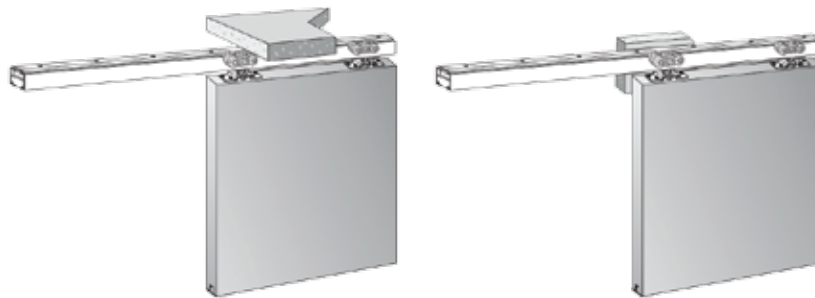
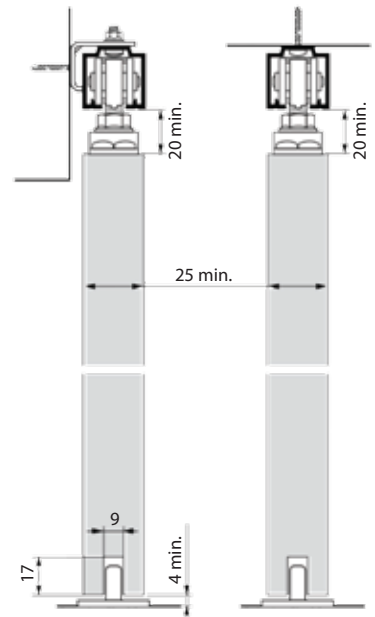
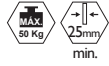

CALHA K-45

ALUMÍNIO

Código

Acabamento

I50K45

NATURAL

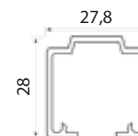
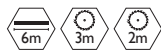

CARRO 3450

Código

I503450



SISTEMA DE CORRER PARA PORTAS

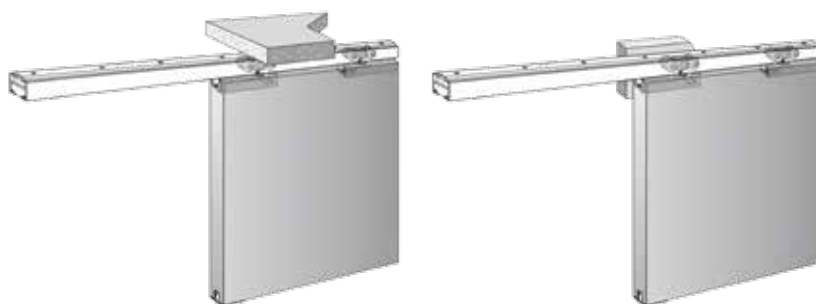
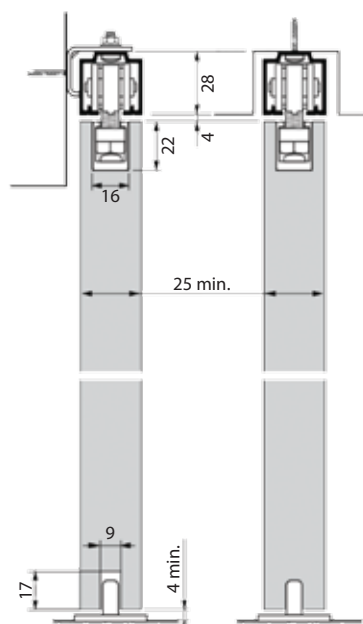

CALHA K-45

ALUMÍNIO

Código

Acabamento

I50K45

NATURAL

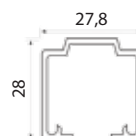

CARRO 345I RETRAC

Código

I50345I



SISTEMA DE CORRER PARA PORTAS

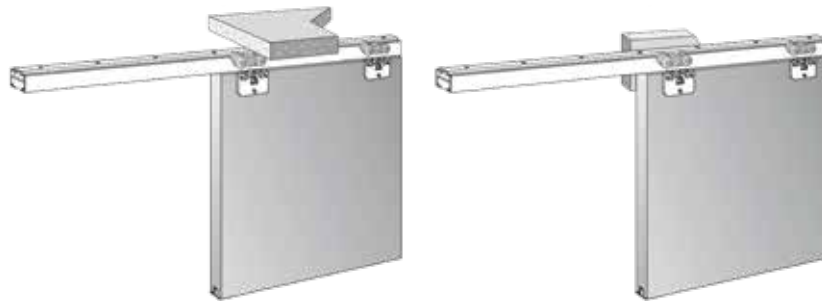
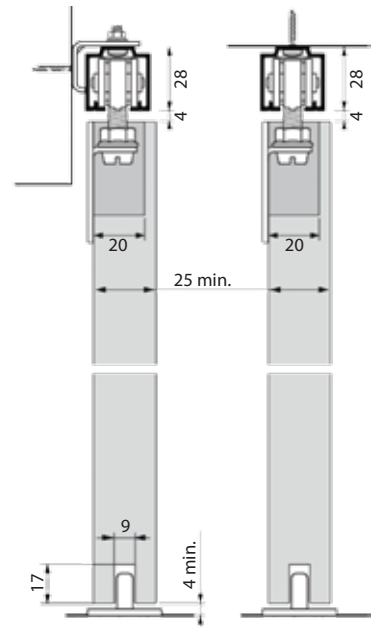
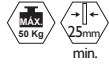

CALHA K-45



ALUMÍNIO

Código

Acabamento

I50K45

NATURAL

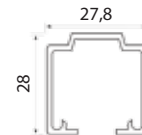

CARRO 3452



Código

I503452



SISTEMA DE CORRER PARA PORTAS

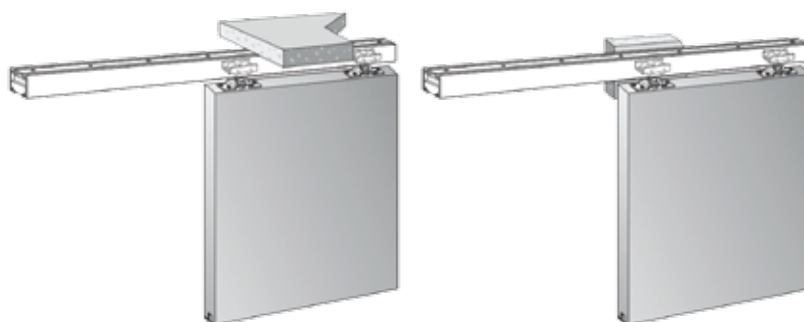
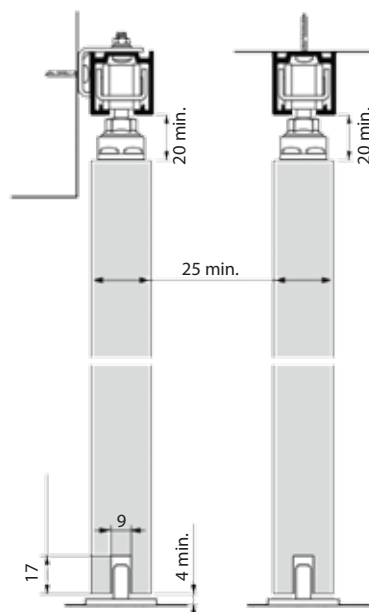
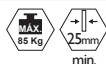

CALHA K-80



ALUMÍNIO

Código

Acabamento

I50K80

NATURAL

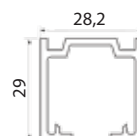

CARRO 3720



Código

I503720



SISTEMA DE CORRER PARA PORTAS

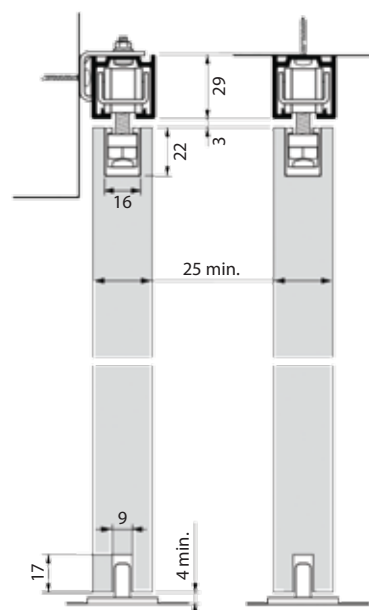
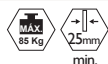

CALHA K-80

ALUMÍNIO

Código

Acabamento

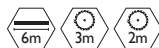

I50K80

NATURAL

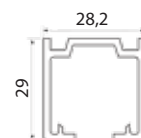

CARRO 3727

Código



I503727





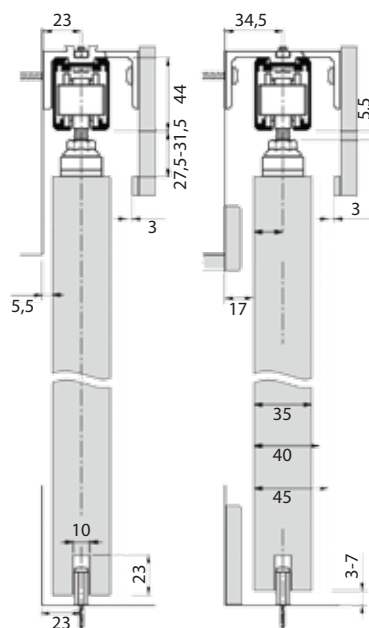





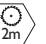

SISTEMA DE CORRER PARA PORTAS

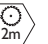

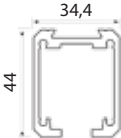
A5.28

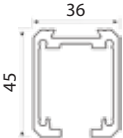
FERRAGENS > SISTEMAS DE CORRER > SISTEMA SLID 90/I 30

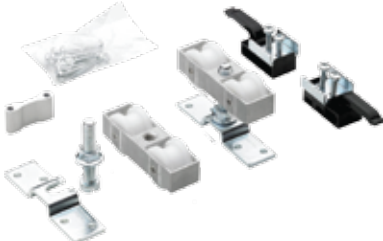
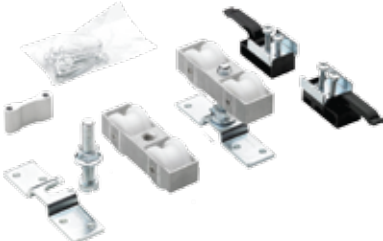
CALHA K-90		ALUMÍNIO	Código	Acabamento	CALHA K-130		ALUMÍNIO	Código	Acabamento
			150K90	NATURAL				150K130	NATURAL
									
CARRO SLID 90				Código	CARRO SLID 130				Código
				1502701					1502721
									

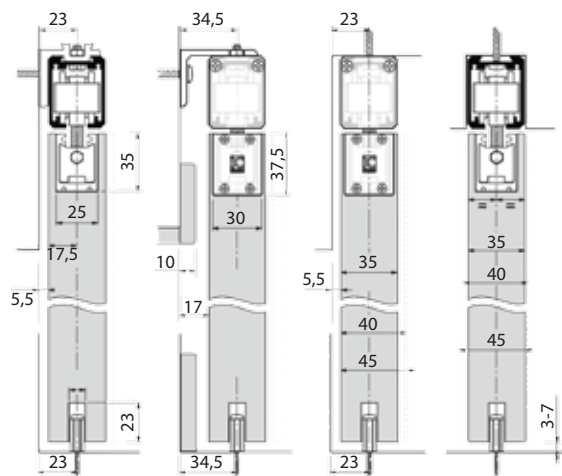
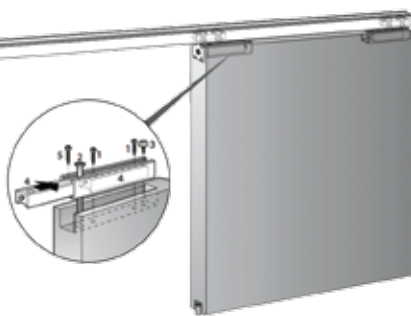

CALHA K-90

ALUMÍNIO

Código

Acabamento



??2748

NATURAL

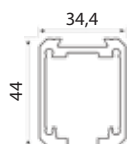

CALHA K-130

ALUMÍNIO

Código

Acabamento



??2758

NATURAL

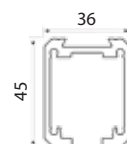

CARRO SLID 90 R

Código



1502705

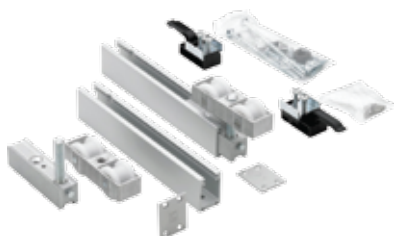

CARRO SLID 130 R

Código



1502725

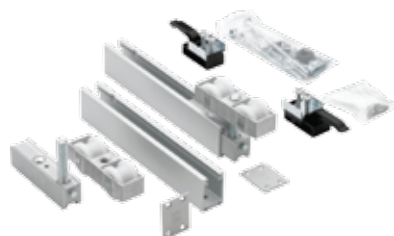

SISTEMA DE CORRER PARA PORTAS DE FOLE

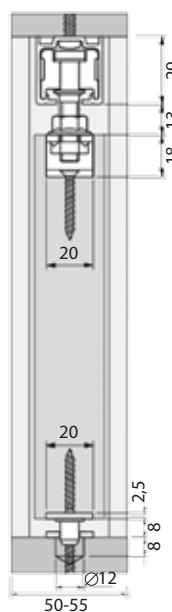
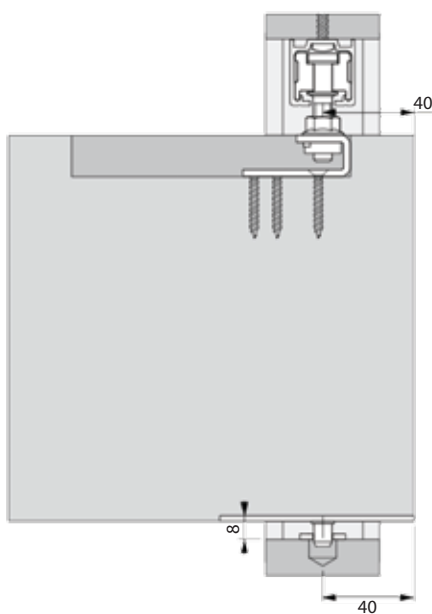

A5.30

FERRAGENS > SISTEMAS DE CORRER > SISTEMA NK PAR 40

CALHA K-80



ALUMÍNIO

Código

Acabamento

150K80

NATURAL

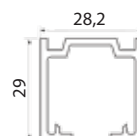

CARRO 3710 P/ ROUPEIRO



Código

1503710

JOGO P/ 2 FOLHAS



SISTEMA DE CORRER PARA PORTAS DE FOLE

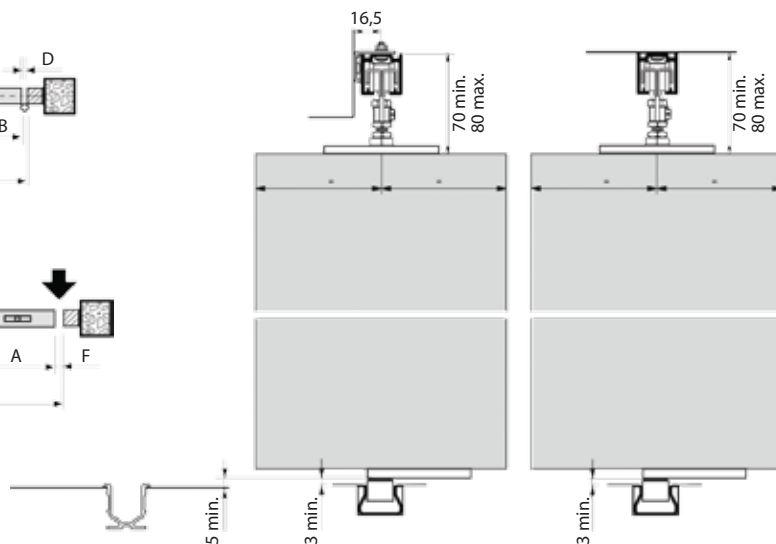
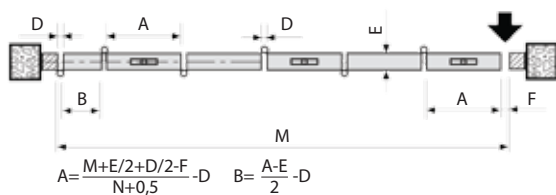
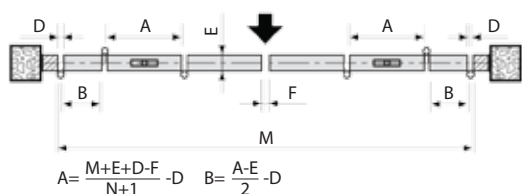
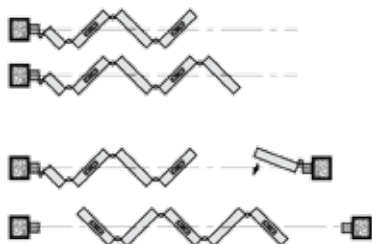
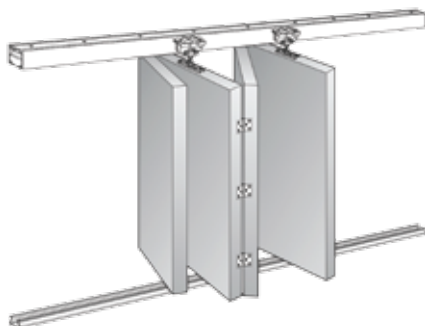
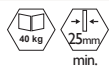

CALHA K-80

ALUMÍNIO

Código

Acabamento



150K80

NATURAL

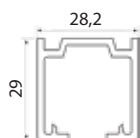

CALHA INF. 41

ALUMÍNIO

Código

Acabamento

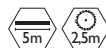

15041

NATURAL



CARRO 3406 P/ FOLE

Código



1503406





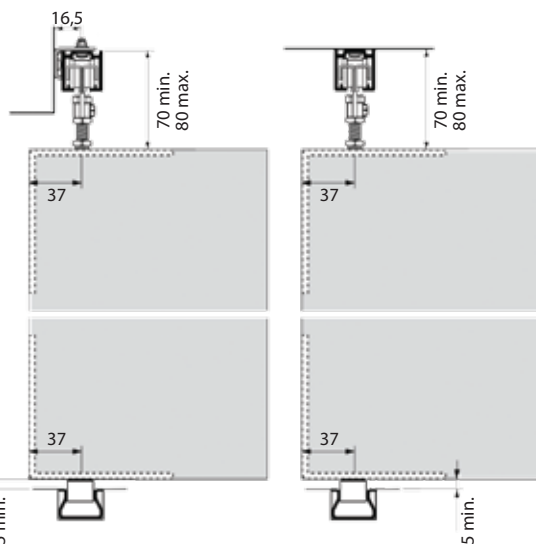
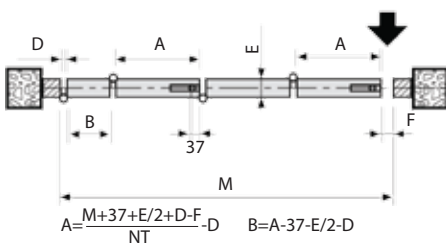
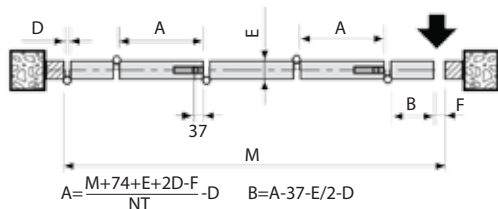
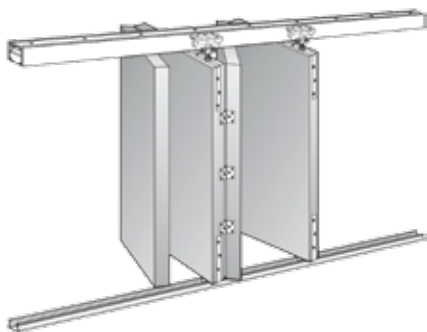
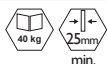



SISTEMA DE CORRER PARA PORTAS DE FOLE

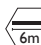

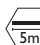
A5.32

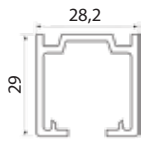
FERRAGENS > SISTEMAS DE CORRER > SISTEMA NK FOLD 40 E

CALHA K-80	ALUMÍNIO	Código	Acabamento	CALHA INF. 41	ALUMÍNIO	Código	Acabamento
  		150K80	NATURAL	 		15041	NATURAL
							

CARRO 3407 P/ FOLE

Código



1503407



SISTEMA DE CORRER PARA PORTAS DE FOLE

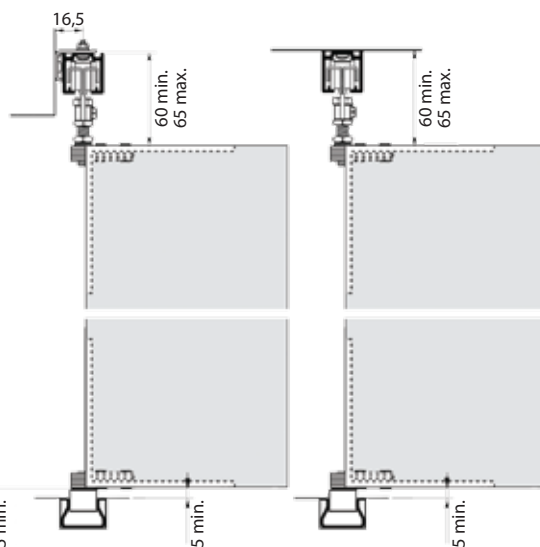
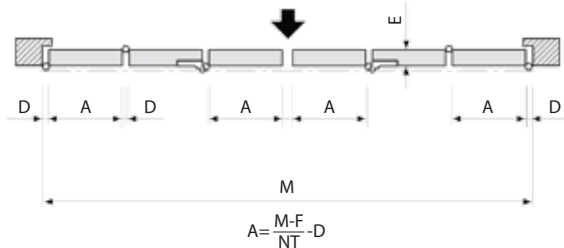
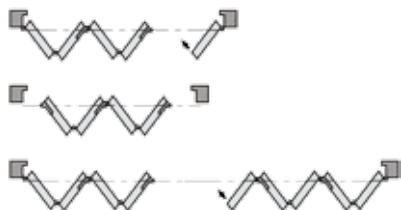
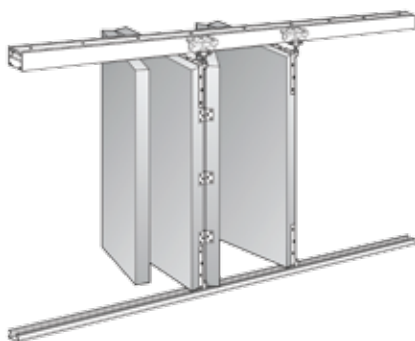
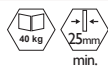

CALHA K-80	ALUMÍNIO	Código	Acabamento	CALHA INF. 41	ALUMÍNIO	Código	Acabamento
		150K80	NATURAL			15041	NATURAL

CARRO 3410 P/ FOLE

Código



1503410



SISTEMA DE CORRER PARA PORTAS DE FOLE

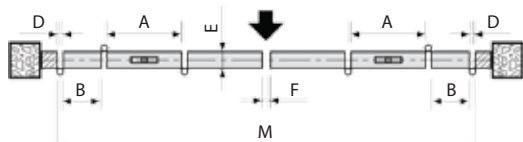
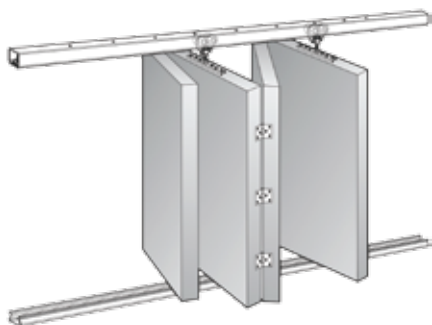

$$A = \frac{M+E+D-F}{N+1} - D \quad B = \frac{A-E}{2} - D$$

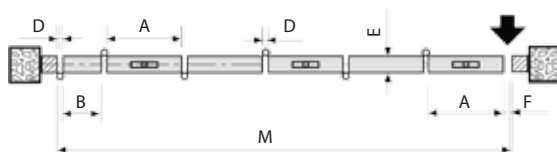

$$A = \frac{M+E/2+D/2-F}{N+0,5} - D \quad B = \frac{A-E}{2} - D$$

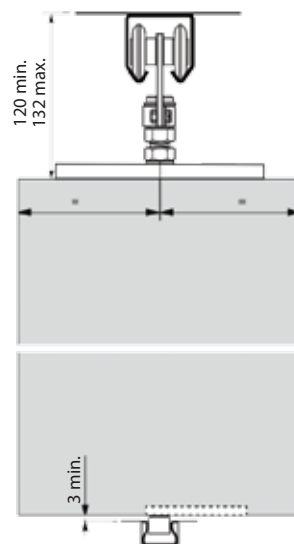
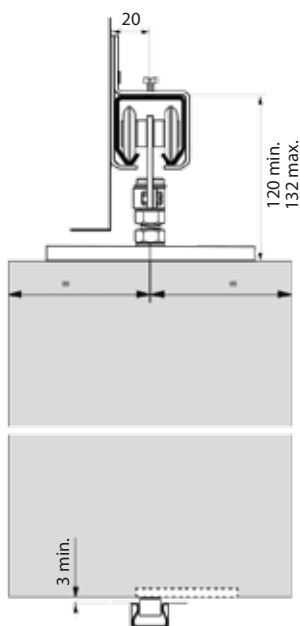

A5.34

FERRAGENS > SISTEMAS DE CORRER > SISTEMA PL 150 C

CALHA PL-150	AÇO	Código	Acabamento	CALHA INF. 41	ALUMÍNIO	Código	Acabamento
		150PL150	NEOCROM			15041	NATURAL

CARRO 3702 PL150 P/ FOLE

Código



1503702



SISTEMA DE CORRER PARA PORTAS DE FOLE

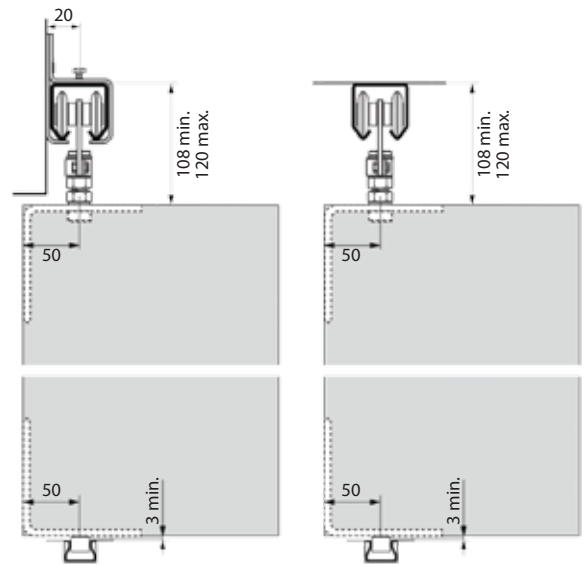
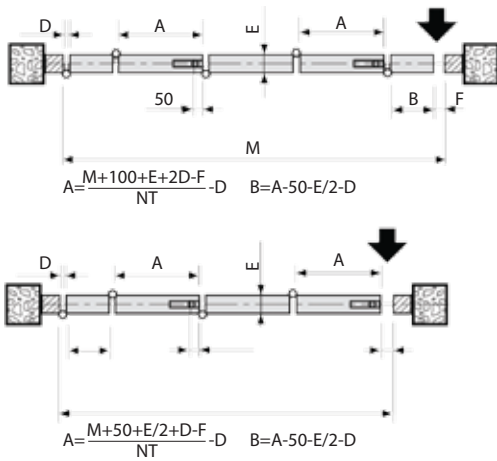
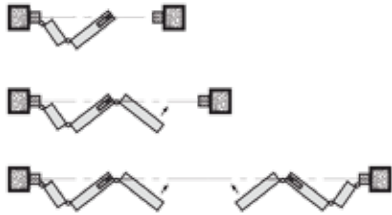
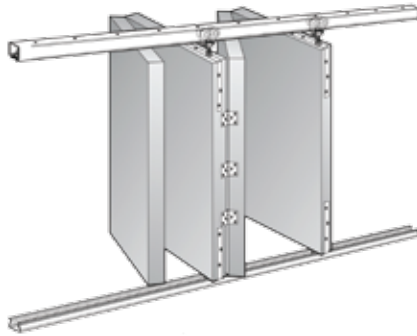

CALHA PL-150

AÇO

Código

Acabamento

CALHA INF. 41

ALUMÍNIO

Código

Acabamento



150PL150

NEOCROM



I5041

NATURAL

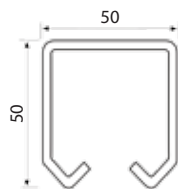

CARRO 3703 PL150 P/ FOLE

Código



1503703



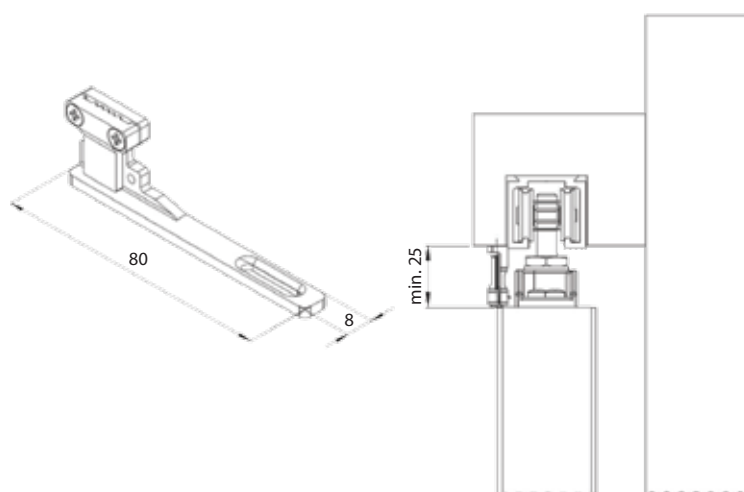
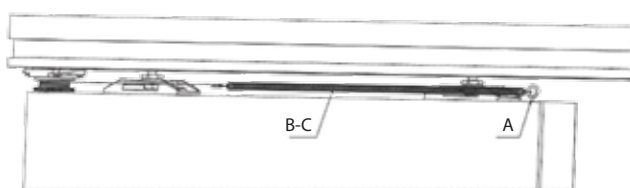
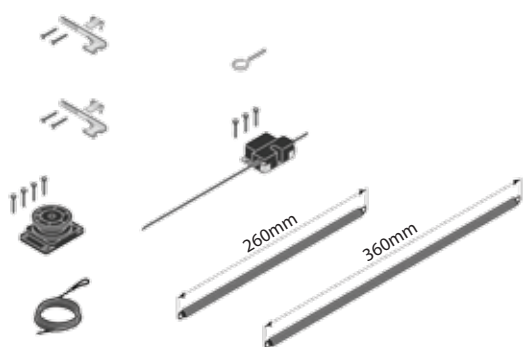

A5.36

FERRAGENS > SISTEMAS DE CORRER > SISTEMA FECHO PORTA AUTOMÁTICO 0880 I

SISTEMA FECHO PORTA AUTOMÁTICO 0880 I

Código



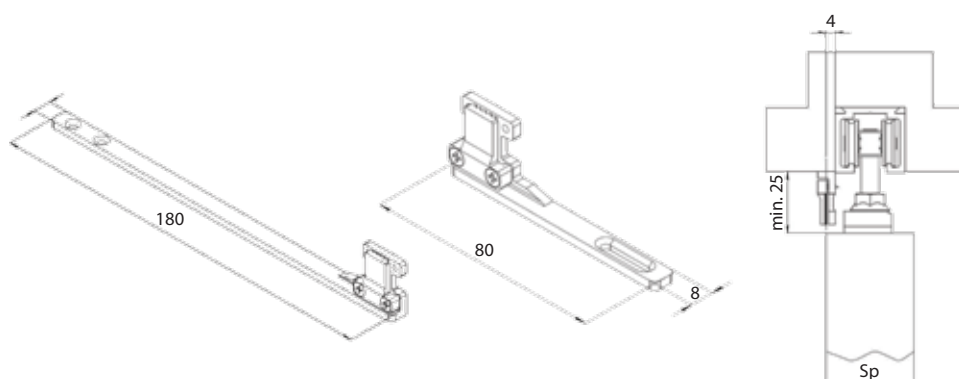
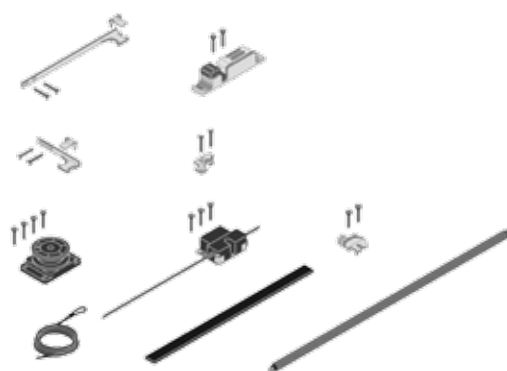

A5.37

FERRAGENS > SISTEMAS DE CORRER > SISTEMA FECHO PORTA AUTOMÁTICO 0880 2

SISTEMA FECHO PORTA AUTOMÁTICO 0880 2

Código

35008802



ACESSÓRIOS P/ SISTEMAS CORRER

AMORTECEDOR CARROS 40kg

Código



35008601



AMORTECEDOR CARROS 80kg

Código



350086080



KIT ABERT. SIMULTÂNEO ENCONTRO

Código



KIT ABERT. SIMULTÂNEO PARALELO

Código



JOGO PORTAS PARALELAS 2000

Código



3502000

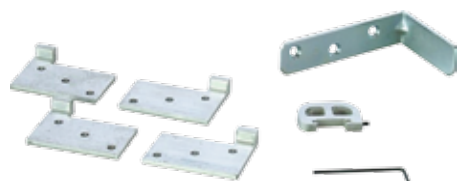

JOGO P. PARALELAS SF-T

Código

ESQ
15010110

DIR
15010111

PELÚCIA P/ CAIXILHO

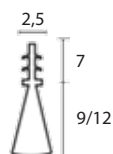

Altura	Código	Acabamento
9mm	213P9BJ	BEJE
9mm	213P9BR	BRANCO
9mm	213P9C	CASTANHO
9mm	213P9P	PRETO
12mm	213P12BJ	BEJE
12mm	213P12BR	BRANCO
12mm	213P12C	CASTANHO
12mm	213P12P	PRETO

BORRACHA P/ CAIXILHO



Código	Acabamento
213BBJ	BEJE
213BBR	BRANCO
213BC	CASTANHO
213BP	PRETO
213BS	SAPELY

SISTEMA DE CORRER PARA PORTAS SINCRONIZADAS

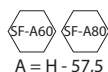

A = H - 57,5

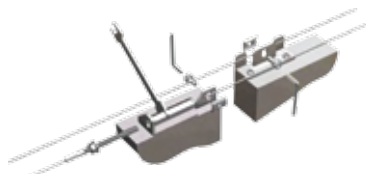
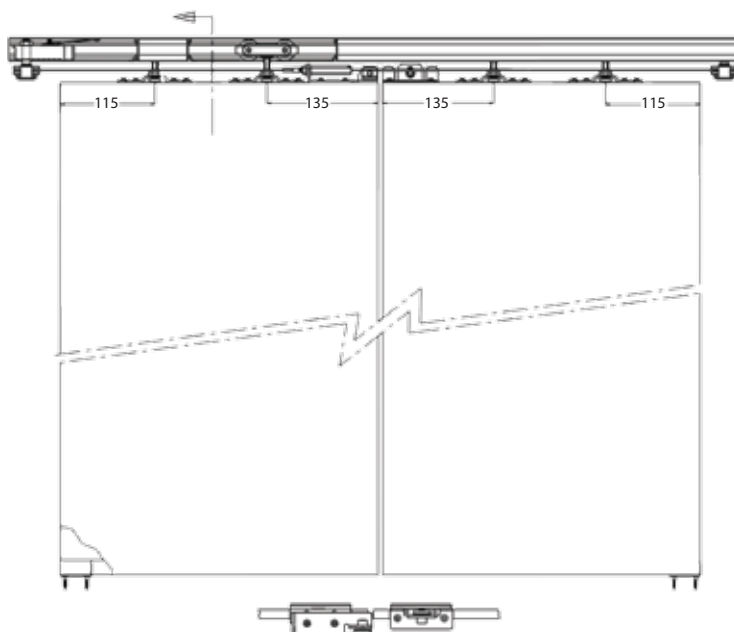

JOGO ACESSÓRIOS 10112 SF-SINCRO 60/80

Código

15010112

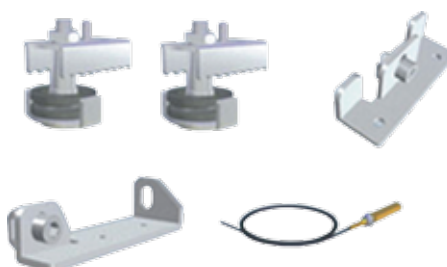

SISTEMA DE CORRER PARA PORTAS SINCRONIZADAS

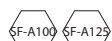
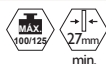

A = H - 60,5

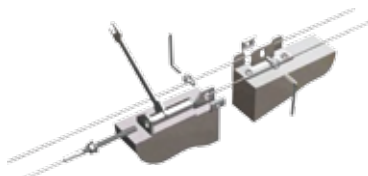
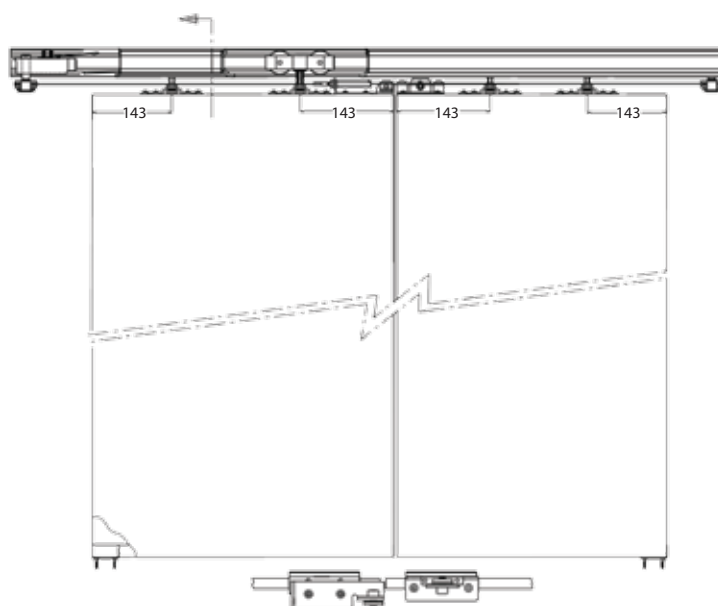
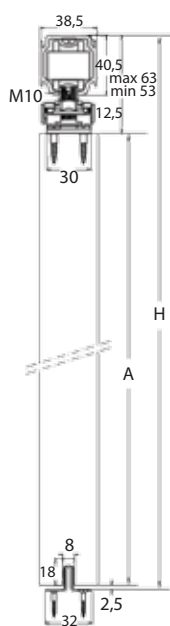

JOGO ACESSÓRIOS 10113 SF-SINCRO 100/125

Código

